

# DEX Chat Tables

(144) 40" Round

(147) 36" Square

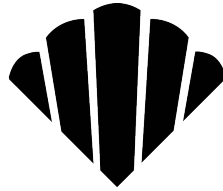

## SEASIDE CASUAL

### ASSEMBLY INSTRUCTIONS

# 1

**PLEASE READ INSTRUCTIONS COMPLETELY BEFORE BEGINNING.**  
Carefully remove contents from box. Make sure that all parts and hardware are included using the Parts List below.

**Tools Required:** #2 Phillips Head Screwdriver;

144 Round Table Top

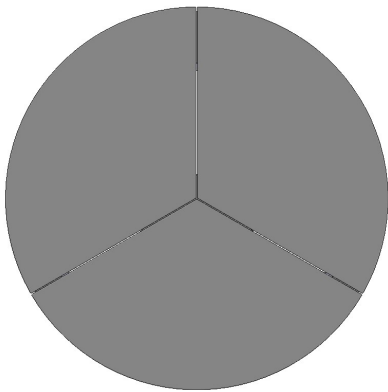

x 1

147 Square Table Top

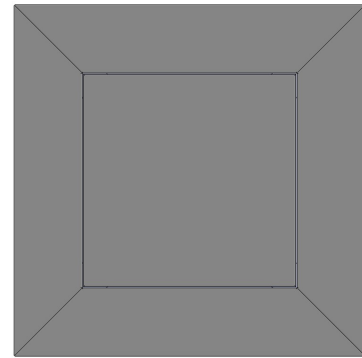

x 1

149 Table Base

Long Leg Assembly

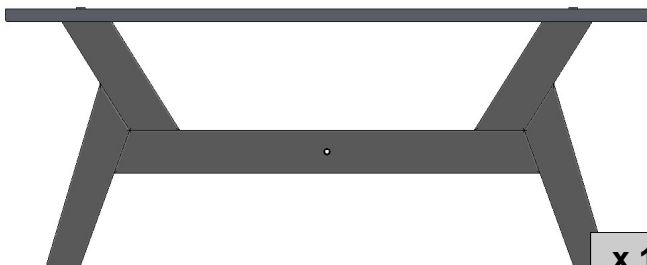

x 1

Short Leg Assembly

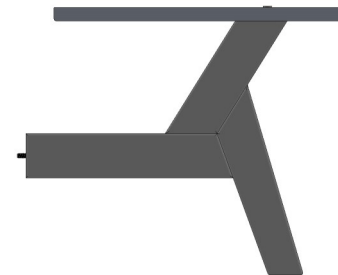

x 2

1-3/4" Phillips Head Screw

Actual Size

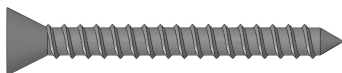

Part Code: 316-8X1-3/4PFDS

x 2

3/4" Phillips Pan Head Screw

Actual Size

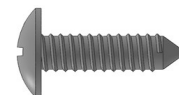

Part Code: 316-8X3/4PTS

x 24

WARRANTY QUESTIONS OR COMMENTS PLEASE CALL TOLL FREE AT 1-800-809-3114

**2****ATTACH SHORT LEG ASMBLS TO LONG LEG ASSEMBLY**

Thread Hanger Bolts in Short Leg Assemblies into the Insert Nuts in the Long Leg Assembly. Spin clockwise until tight, and aligned as shown.

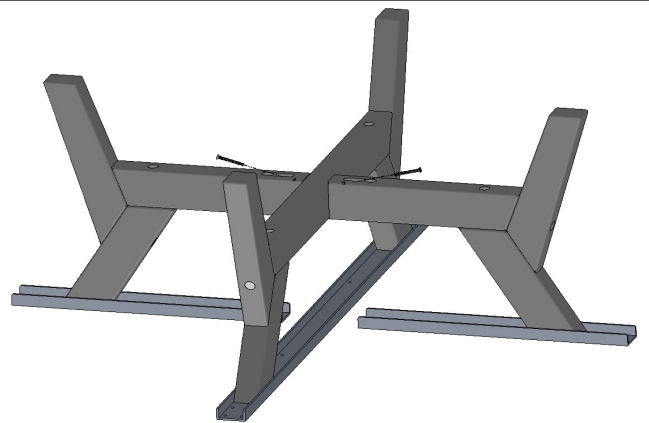
**3****SECURE SHORT LEG ASMBLS TO LONG LEG ASSEMBLY**

Secure using (2) 1-3/4" Phillips Head Screws through pockets in Short Leg Assemblies.

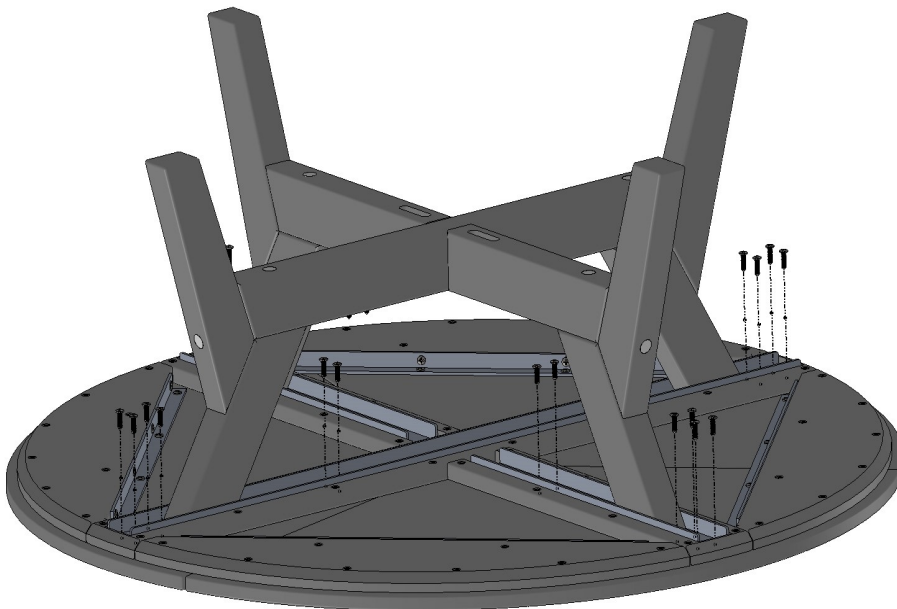
**4****SECURE BASE TO TABLE TOP**

Align aluminum on Base Assembly to pockets in Table Top Assembly. Attach Base to Table Top using (24) 3/4" Phillips Pan Head Screws.