

01 TOP VIEW

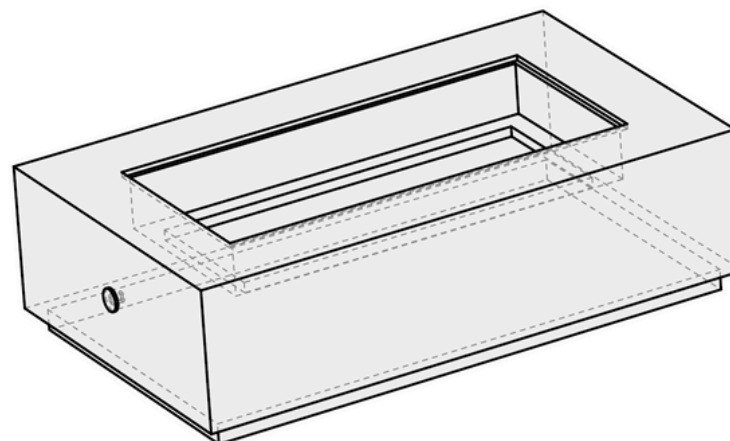

04 PERSPECTIVE

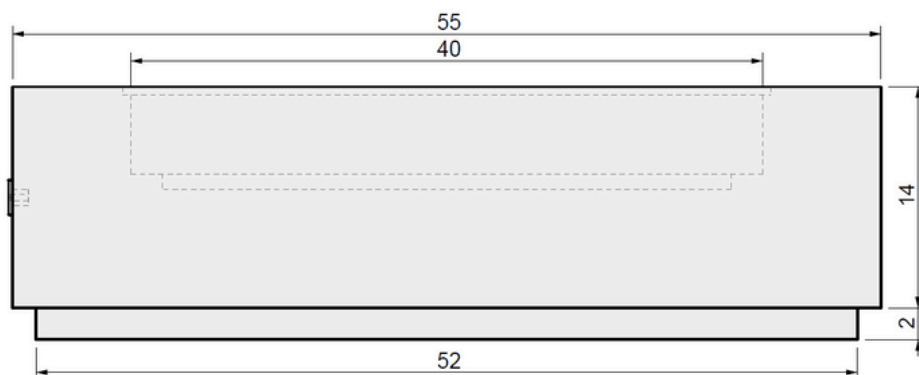

02 FRONT VIEW

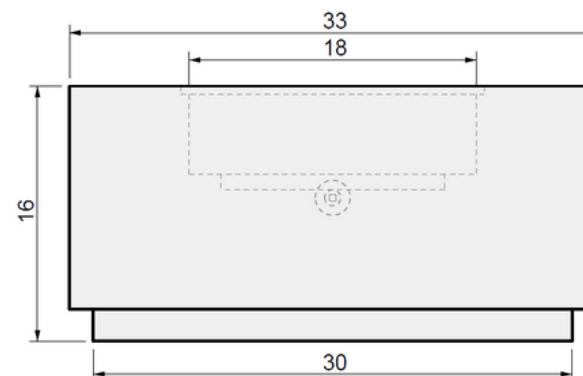

03 SIDE VIEW



MONTANA  
FIRE PITS

[www.montanafirepits.com](http://www.montanafirepits.com)

**CONFIDENTIAL**

Any information data and drawings embodied in this document are proprietary and strictly confidential, are to be held as confidential and supplied with the understanding that they will not be disclosed, in whole or in part or in any form, to third parties without the prior written consent of Montana Fire Pits. All information, illustrations, screen shots, and data contained are herein Copyright © Montana Fire Pits. All rights reserved.

**Model:** Lumera Fire Table

**Size:** 55" L x 33" W x 16" H

**Material:** GFRC

**Burner:** UL150 - 150K BTU Linear Burner

**Fuel Pressure:** Natural Gas: 7" Water Column  
Propane: 11" Water Column

**Weight:** 250 lbs.

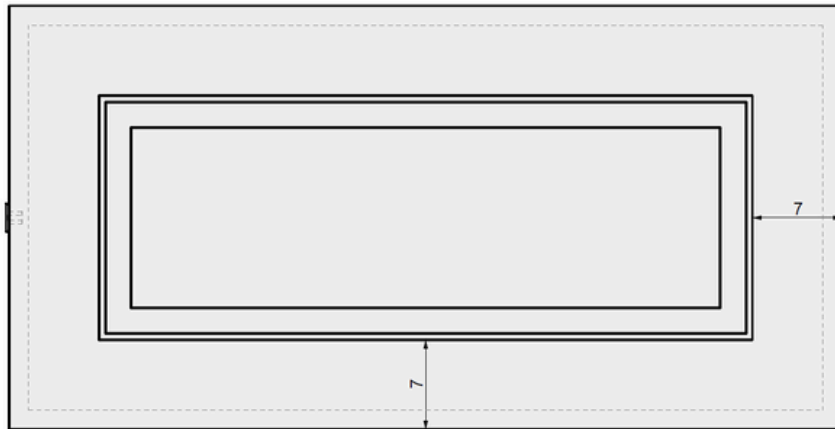

01 TOP VIEW

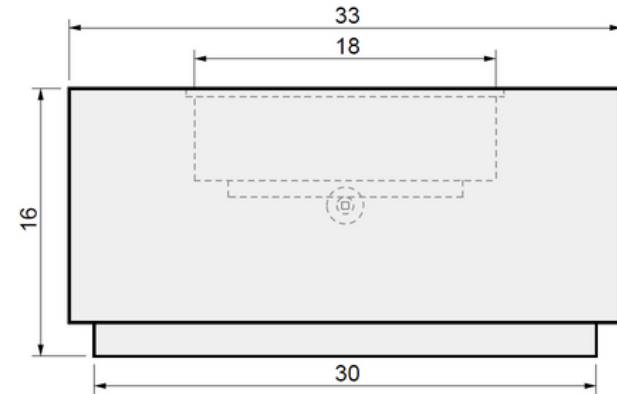

03 SIDE VIEW

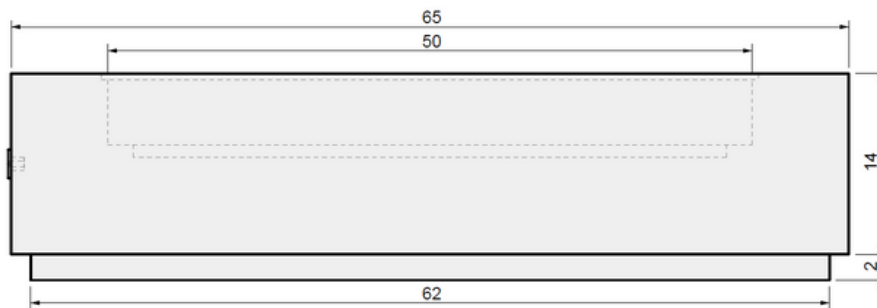

02 FRONT VIEW

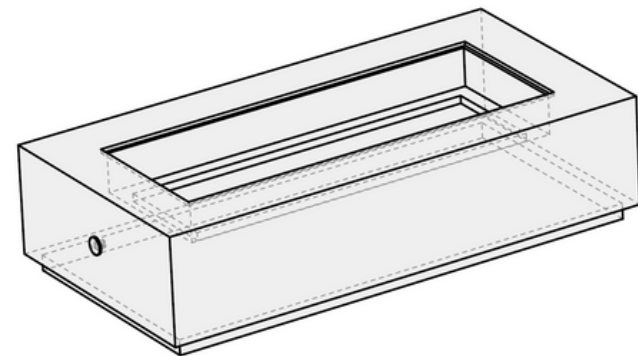

04 PERSPECTIVE



MONTANA  
FIRE PITS

[www.montanafirepits.com](http://www.montanafirepits.com)

**CONFIDENTIAL**

Any information data and drawings embodied in this document are proprietary and strictly confidential, are to be held as confidential and supplied with the understanding that they will not be disclosed, in whole or in part or in any form, to third parties without the prior written consent of Montana Fire Pits. All information, illustrations, screen shots, and data contained are herein Copyright © Montana Fire Pits. All rights reserved.

**Model:** Lumera Fire Table

**Size:** 65" L x 33" W x 16" H

**Material:** GFRC

**Burner:** UL210 - 210K BTU Linear Burner

**Fuel Pressure:** Natural Gas: 7" Water Column  
Propane: 11" Water Column

**Weight:** 400 lbs.

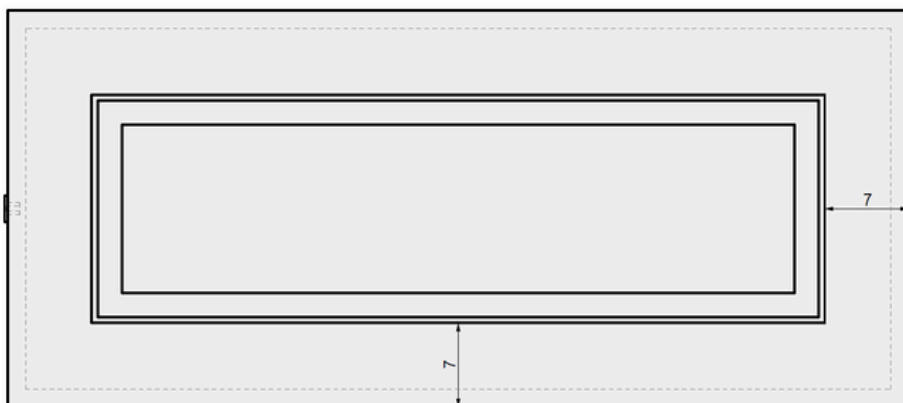

01 TOP VIEW

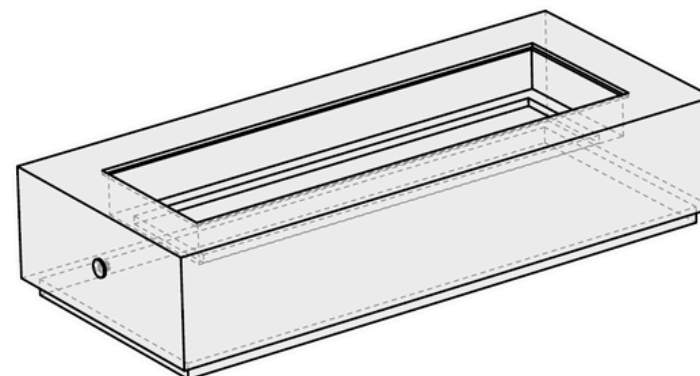

04 PERSPECTIVE

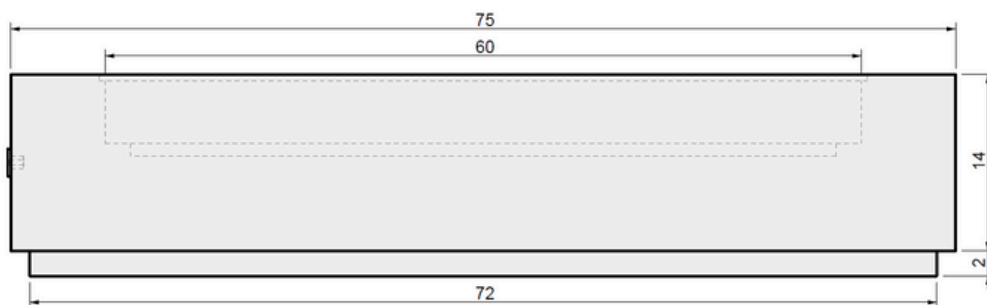

02 FRONT VIEW

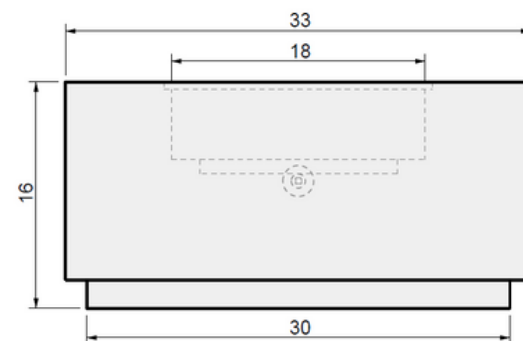

03 SIDE VIEW



MONTANA  
FIRE PITS

[www.montanafirepits.com](http://www.montanafirepits.com)

**CONFIDENTIAL**

Any information data and drawings embodied in this document are proprietary and strictly confidential, are to be held as confidential and supplied with the understanding that they will not be disclosed, in whole or in part or in any form, to third parties without the prior written consent of Montana Fire Pits. All information, illustrations, screen shots, and data contained are herein Copyright © Montana Fire Pits. All rights reserved.

**Model:** Lumera Fire Table

**Size:** 75" L x 33" W x 16" H

**Material:** GFRC

**Burner:** UL250 - 250K BTU Linear Burner

**Fuel Pressure:** Natural Gas: 7" Water Column  
Propane: 11" Water Column

**Weight:** 450 lbs.

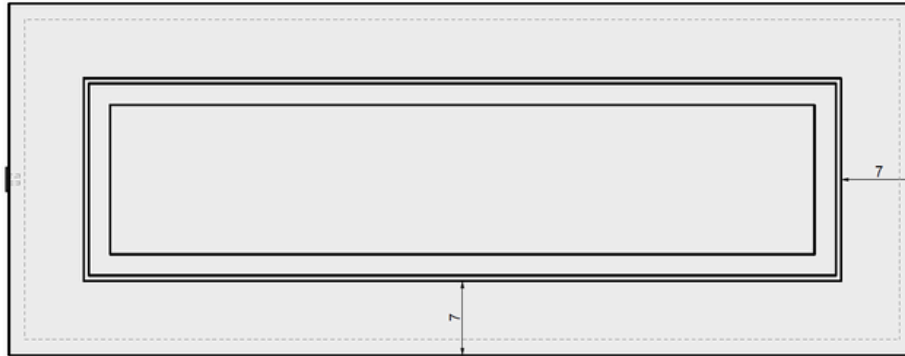

01 TOP VIEW

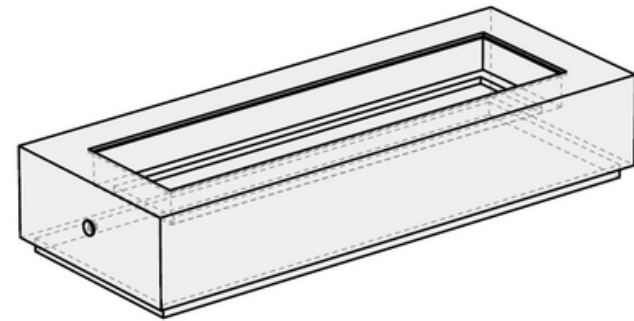

04 PERSPECTIVE

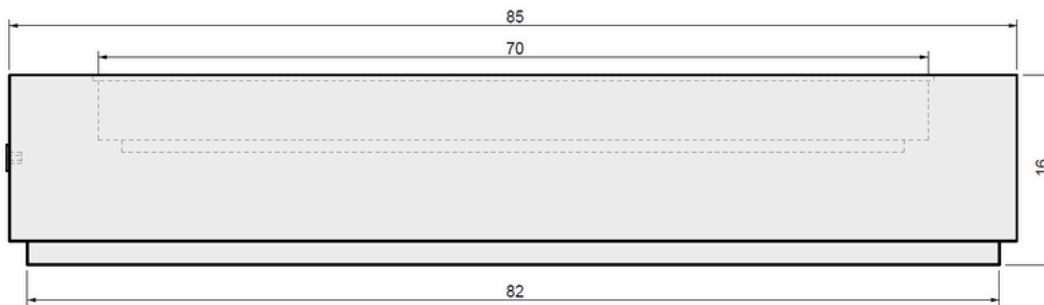

02 FRONT VIEW

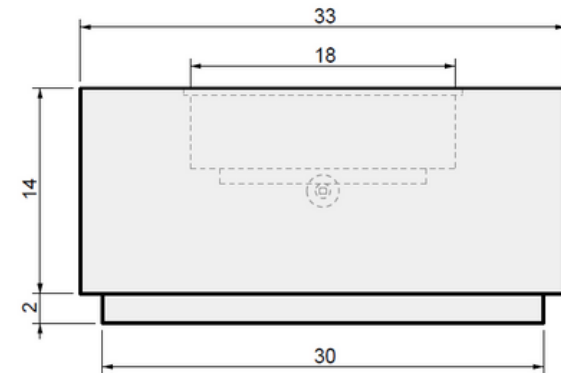

03 SIDE VIEW



MONTANA  
FIRE PITS

[www.montanafirepits.com](http://www.montanafirepits.com)

**CONFIDENTIAL**

Any information data and drawings embodied in this document are proprietary and strictly confidential, are to be held as confidential and supplied with the understanding that they will not be disclosed, in whole or in part or in any form, to third parties without the prior written consent of Montana Fire Pits. All information, illustrations, screen shots, and data contained are herein Copyright © Montana Fire Pits. All rights reserved.

**Model:** Lumera Fire Table

**Size:** 85" L x 33" W x 16" H

**Material:** GFRC

**Burner:** UL270 - 270K BTU Linear Burner

**Fuel Pressure:** Natural Gas: 7" Water Column  
Propane: 11" Water Column

**Weight:** 500 lbs.

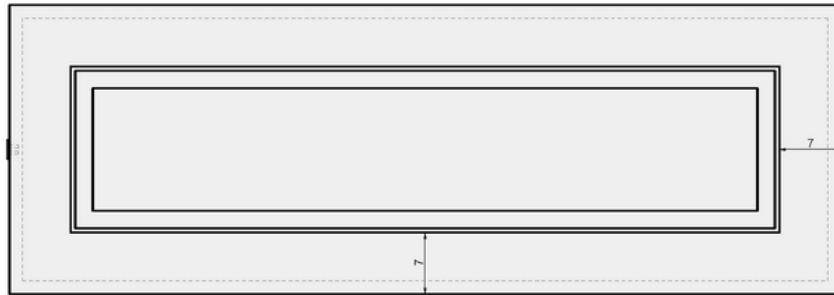

01 TOP VIEW

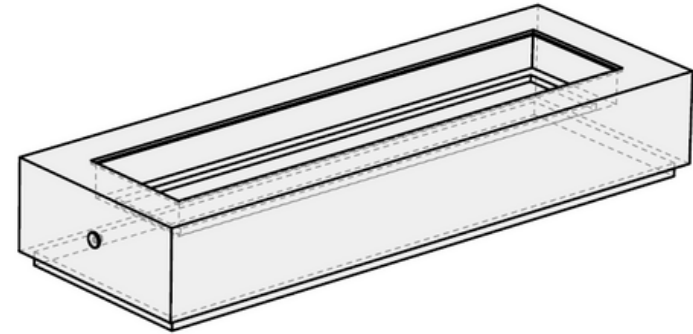

04 PERSPECTIVE

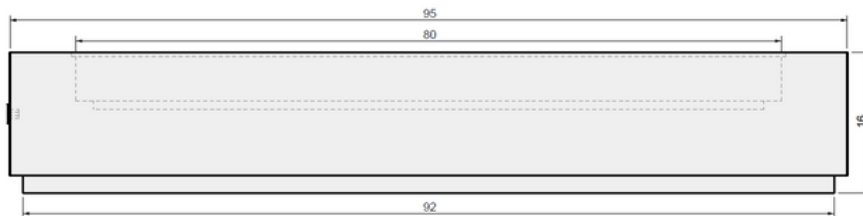

02 FRONT VIEW

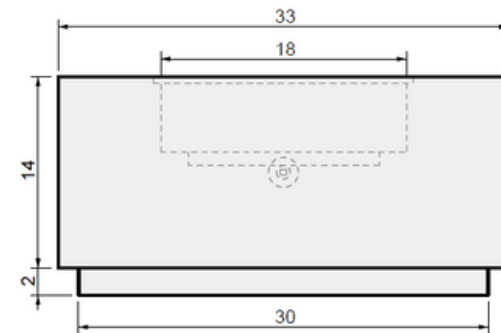

03 SIDE VIEW



MONTANA  
FIRE PITS

[www.montanafirepits.com](http://www.montanafirepits.com)

**CONFIDENTIAL**

Any information data and drawings embodied in this document are proprietary and strictly confidential, are to be held as confidential and supplied with the understanding that they will not be disclosed, in whole or in part or in any form, to third parties without the prior written consent of Montana Fire Pits. All information, illustrations, screen shots, and data contained are herein Copyright © Montana Fire Pits. All rights reserved.

**Model:** Lumera Fire Table

**Size:** 95" L x 33" W x 16" H

**Material:** GFRC

**Burner:** UL270 - 270K BTU Linear Burner

**Fuel Pressure:** Natural Gas: 7" Water Column  
Propane: 11" Water Column

**Weight:** 575 lbs.